

**“It is like a concrete grinder  
on steroids”**

Mark Hunt

Central US Coatings



## Introducing the WerkMaster RAIDER XL5

Our latest innovation to the WerkMaster lineup of professional grinding & polishing machines



**Eliminate up to 90% of edging  
labour VS hand grinding!**

A compact and powerful  
Edger, Grinder and Polisher that  
gets to 1/8" of the wall.  
Use on concrete, stone, terrazzo  
and hardwood.



**17"**  
Footprint

**EDGES TO WITHIN 1/8" TO THE WALL**

No additional equipment required  
Saving you Time and Money!



**Dual Port Dust Pickup**

Grind Virtually **Dust Free** with our new Dual Port Dust Pick Up and Urethane Dust Skirt

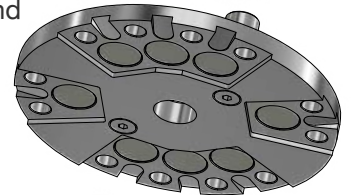
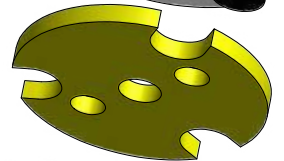
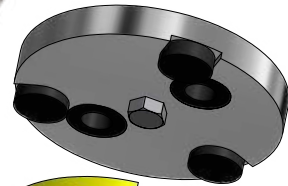

**Plug 'N Go Tooling**

Use with quick change **ULTRA-FLEX Plug 'N Go** tooling system. Easy to install.

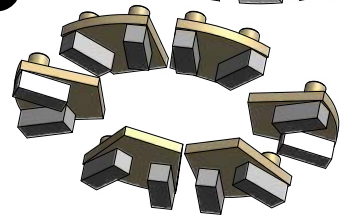

**Forward/Reverse**

Change the direction of your tooling direction with the flick of a switch!



**Tech Specs**

Footprint: in (cm)	17 (43)
Disc Size: in (cm)	6 (15.2)
Weight: lbs (Kg)	362 (164.2)
VFD	400-1160 RPM
Horsepower	5
Voltage	200-230
Electric Phase: Ph	1~ / 3~
Vacuum Req	200 CFM
Breaker Size	30 AMP
Min. Generator (kW)	6.0+